

REF

UDK1000, UDK600

Universal Drainage Procedure

en Universal Drainage Procedure

es Procedimiento de drenaje Universal

USA

STERILE EO



For Single Use Only

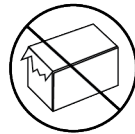

Do not use if
package is damaged.



Not made with
natural rubber.



Not made with
latex.

Jigsaw Medical Universal Drainage Kit

Drain line for smooth fit cateter

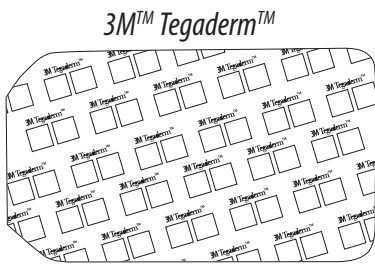
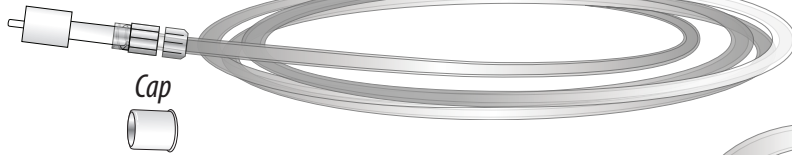

Split Foam

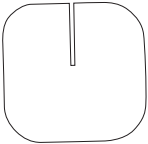

Alcohol Pad



Sterile Gloves



Gauze Pads

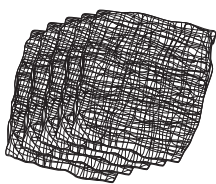

Blue Valve Cap



Emergency Slide Clamp



Barrier Film

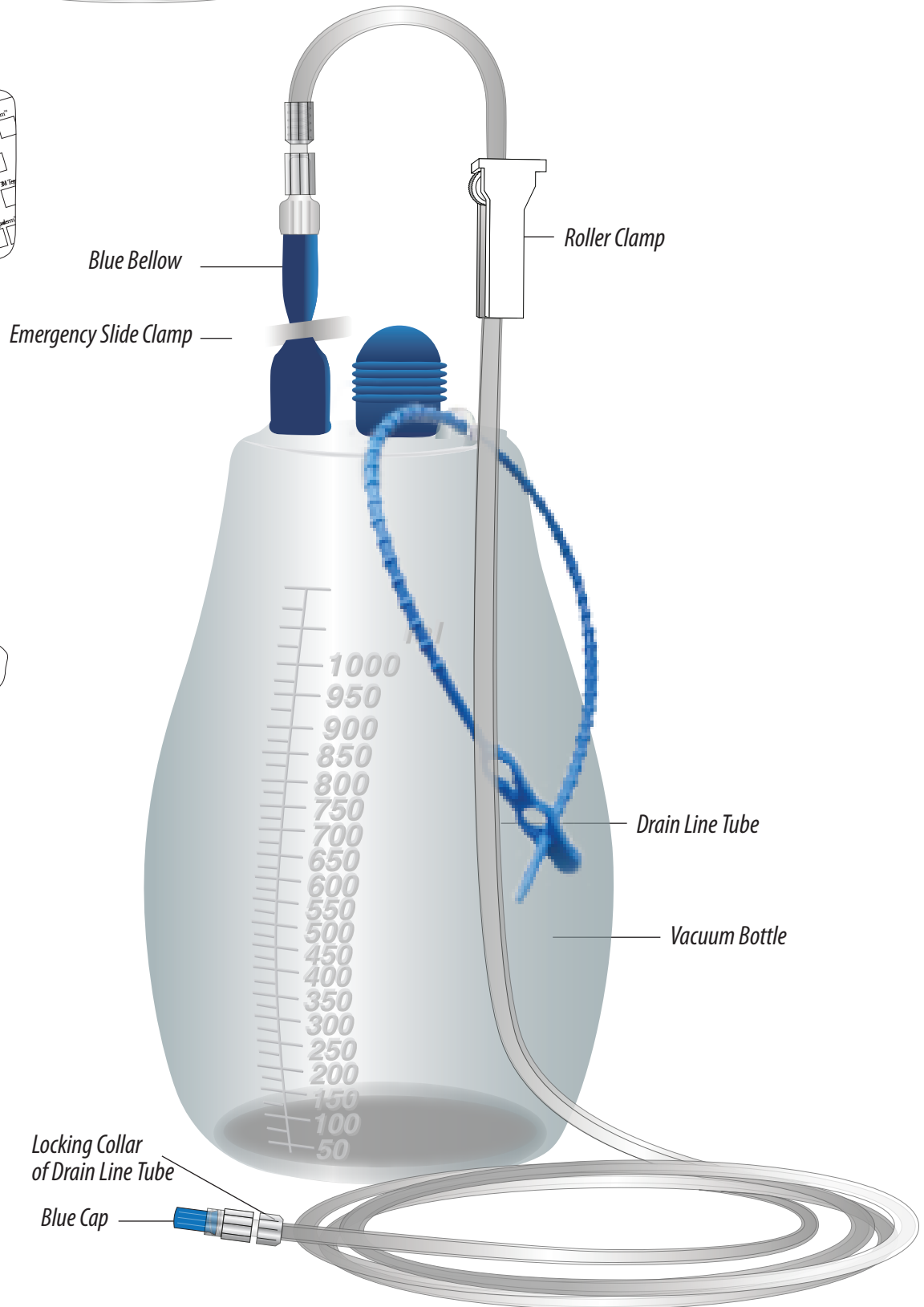

Blue Bellow

Emergency Slide Clamp

Roller Clamp

Drain Line Tube

Vacuum Bottle

Locking Collar of Drain Line Tube

Blue Cap

Preliminary Steps

1 Check to make sure you have all items in the kit and a clean, flat work area. Complete kit on diagram with contents labeled on next page.

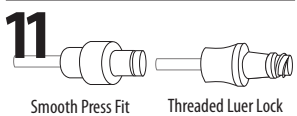
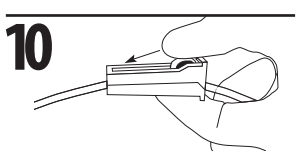
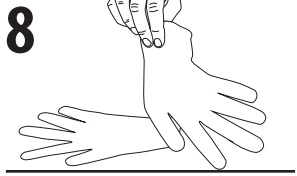
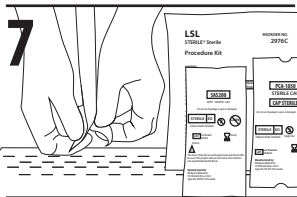
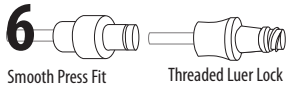
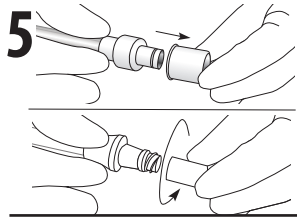
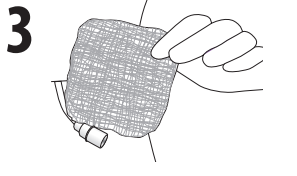
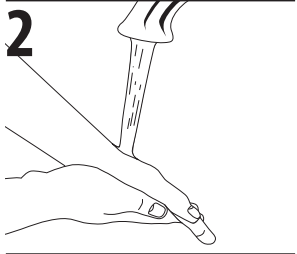

How to connect a Smooth Catheter. If you have a Threaded Catheter skip these steps.

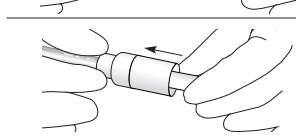
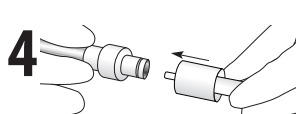
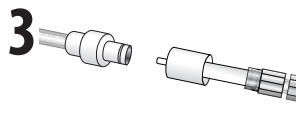
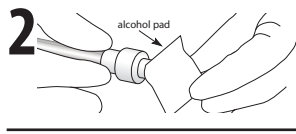
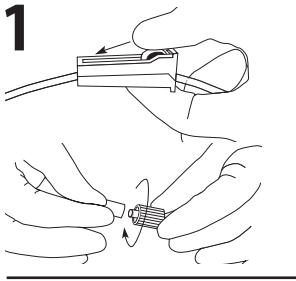

How to connect a Threaded Catheter. If you have a Smooth Catheter skip these steps.

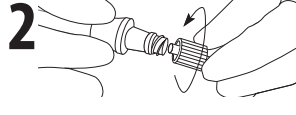

Begin Drainage

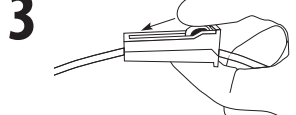
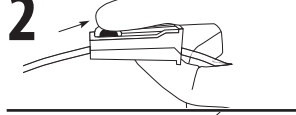
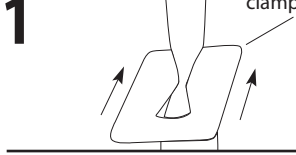

To Disconnect the Smooth Catheter.

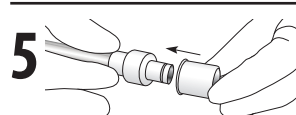
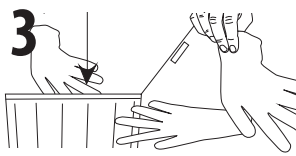
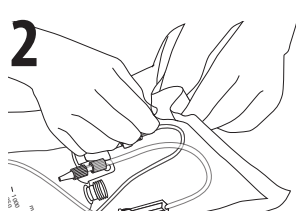
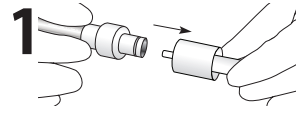

To Disconnect the Threaded Catheter.

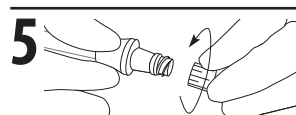
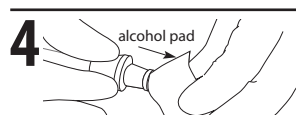
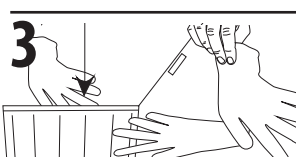
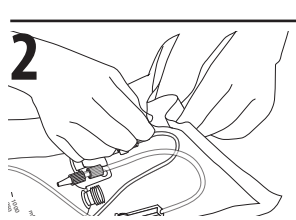
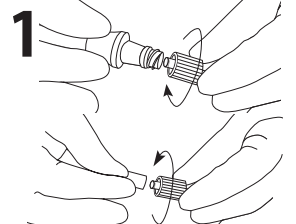

Final Steps.

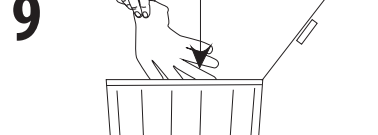
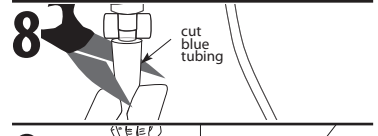
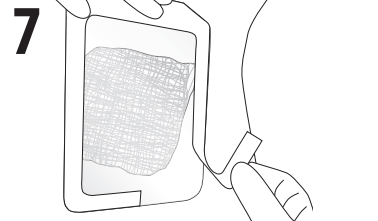
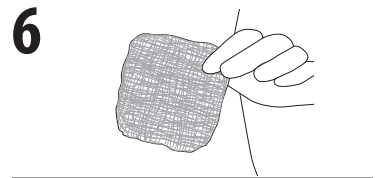
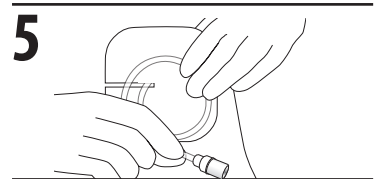
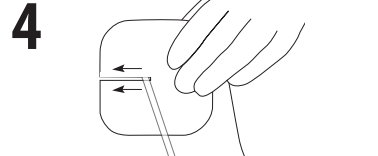
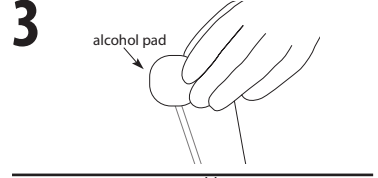
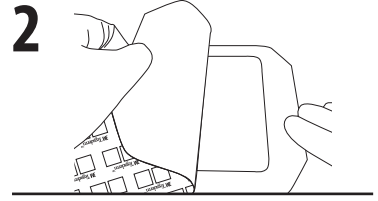
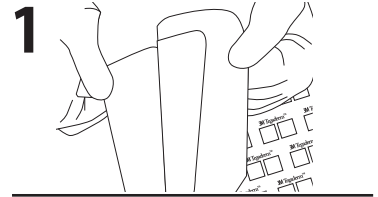

Jigsaw Medical

Solving the healthcare puzzle one product at a time

www.jigsawmed.com

1012 Airpark Dr., Suite 1, Sugar Grove, IL 60554

Tel: 630-587-0019 | Fax: 630-524-9088

Email: info@jigsawmed.com

Instructions for Use

Jigsaw Medical Universal Home Drainage Kit

Read all instructions thoroughly before drainage. Your home healthcare nurse or physician should train you on how to use this kit. Contact your healthcare practitioner with any question or concerns.

Warnings

Always follow the doctor's instructions for maximum drainage volumes. If uncertain, do not drain more than 1000 ml from the chest or 2000 ml from the abdomen at any one time.

During the drainage procedure it is not uncommon for patients to feel some discomfort. Slowing the flow of drainage by closing the roller clamp slightly can alleviate some of this pain. If the pain continues or is intolerable do not hesitate to call your doctor or nurse, as this can be a sign of infection.

Be careful to protect the sterility of the sterile items in the kit. Make sure to keep the catheter valve clean. To reduce the risk of infection, keep it away from other items.

Do not use scissors or other sharp objects near the catheter. If you accidentally puncture the catheter, proceed as follows:

1. Pinch the catheter closed with your fingers.
2. Slip the blue emergency clamp over the catheter between the puncture and the patient. Push the catheter completely into the small end of the slide clamp to close off the catheter.
3. Notify your doctor.

The Safety Adapter should be the only item inserted into the press-fit style catheter valve. Use caution around this connection and make sure it is always secure. If it is disconnected, you must clean the valve with one of the alcohol pads and use a new Safety Adapter. Never reuse a Safety Adapter.

Cautions

All products are for single use only. Do not reuse any of the items as this may contribute to contamination or a faulty product.

Be careful when handling the fluid during and after drainage. It is very important to close the roller clamp once drainage is complete. Keep the bottle upright and below your catheter site so that fluid does not flow back into the catheter. This fluid is not sterile.

To preserve the negative pressure in the bottle, always keep the roller clamp closed unless you are draining fluid.

Keep open flames away from the alcohol pads as they are flammable.

Be cautious around the drain line connections, do not tug or pull on the line or Safety Adapter.

As with any medical procedure, complications may arise. In the chest these include, but are not limited to, pneumothorax, re-expansion pulmonary edema, hypotension, circulatory collapse and infection. In the abdomen potential difficulties include hypotension, circulatory collapse, electrolyte imbalance, protein depletion, ascites leakage, peritonitis, wound infection, and loculations of the peritoneal space.

The Indwelling Catheter

An indwelling catheter is a soft tube or drain that your doctor has recommended for the removal of fluid from your abdomen or chest. When excessive buildup of fluid occurs and you experience discomfort, the fluid can quickly and easily be removed using the Jigsaw Medical Universal Home Drainage Kit.

Before you return home your doctor will instruct you on the frequency of your drainage. After drainage has been completed and the fluid has been removed, the bottle is disconnected and disposed of.

The catheter is then cleaned, re-capped and covered with a clean, flat dressing so that it is not visible under your clothing. Your treatment should not interfere with any of your normal activities when your insertion sites have healed.

What is in your Jigsaw Medical Universal Home Drainage Kit

The Jigsaw Medical Universal Home Drainage Kit was developed to meet the needs of multiple different manufacturers' catheter systems; therefore some of these components may not be used for your specific catheter.

- 1 High Vacuum Drainage Bottle
- 1 Standard Drain Line with Safety Adapter
- 1 Standard Drain Line
- 1 Universal Valve Cap
- 1 Sterile Procedure Kit with the following inside:
 - Tegaderm™ Dressing

Split Foam Pads
8 Alcohol Pads
2 Pairs of Chemo-Rated Gloves
12 ea. 4x4 Gauze
1 Valve Cap
Safety Clamp
Cavilon™ Barrier Film

Drainage Instructions for the Jigsaw Medical Universal Home Drainage Kit:

The following instructions are for use with the Jigsaw Medical Universal Home Drainage Kit. Follow any other instructions your doctor or nurse has recommended along with these steps. Consult your doctor or nurse with any questions.

Follow along using the pictures provided on Page 2.

Preliminary Steps

1. Check to make sure you have all items in the kit and a clean, flat work area.
2. Scrub your hands with soap and water for a few minutes.
3. Carefully remove the old catheter dressing. If signs of infection (redness, swelling or fluid) are present, proceed with drainage if it is not too painful and notify the doctor immediately. Scrub your hands again with soap and water for a few minutes.
4. Remove the Procedure Kit from its packaging and carefully unfold the wrapping on top of your work space, leaving the enclosed sterile items on the wrapping. Take care to always protect sterility of items contained within the kit. Do not touch the sterile items inside with bare hands.
5. Remove the cap on your catheter if present.
6. Identify your catheter using the pictures (Figure 6, Preliminary Steps). There are two types of catheters, one that has threading on the tip (Luer Lock) and one that does not (smooth press-fit). If you have a threaded Luer Lock catheter you will not be using the standard drain line with the safety adapter but you will need to sterile replacement cap that is in the same package. Please set it aside.
7. Carefully open the sterile packages of the bottle and the standard drain line with adapter and cap, drop them onto the sterile wrapping. It is very important that all of these items remain only on the sterile wrapping.

8. Put the gloves on by picking them up by the wrist and putting them on each hand. These gloves are sterile, so the outside should not touch non-sterile items such as your skin or clothing.
9. Tear open the alcohol pads and the Cavilon™ Barrier film antibacterial dressing; do not remove them from their packaging. Set them back on the wrapping for later use.
10. Adjust the roller clamp on the drain line tubing so that it is completely closed by rolling the wheel from its high and unlocked position to its low and closed position.
11. Confirm the type of catheter tip you have implanted as you will need this information for the next steps.

How to connect to a smooth press-fit (non-threaded) style catheter. If you have a threaded Luer Lock catheter please skip these steps.

1. Attach the drain line with adapter to the drainage bottle. To do so remove the blue cap from the male luer lock connector by holding the cap and collar in separate hands and twisting the collar counterclockwise. Do not throw the cap away, place it on the sterile wrapping. Next remove the white cap on the female luer lock on the drainage bottle. Finally take the male luer lock and twist it clockwise onto the female luer lock on the drainage bottle. Ensure that the roller clamp on the drain line with adapter is completely closed.
2. Ensure that the roller clamp on the drain line tubing that is attached to the bottle is completely closed. Remove the blue cap from the male luer connector on the drain line tubing by holding the cap and collar in separate hands, and twisting the collar counterclockwise. **DO NOT DISCARD CAP.** Set it back on the sterile wrapping.
3. Clean around the valve opening with a fresh alcohol pad while holding the base of the catheter valve in one hand.
4. Align the white tip of the Safety Adapter straight on with the opening of the catheter valve.
5. Introduce the Safety Stylet Tip of the Safety Adapter into the valve collar and advance firmly forward until the silicone guard is flush against the white collar. **DO NOT ADVANCE THE STYLET TIP ANY FURTHER. Avoid tension on this connection.**

How to connect to a threaded Luer Lock catheter. If you do not have a threaded Luer Lock catheter please skip these steps as you are ready to begin your drainage.

1. Attach the Standard Drain Line that comes with the bottle to the bottle. To do so remove the blue cap from the male luer lock connector by holding the cap and collar in separate hands and twisting the collar counterclockwise. Do Not Throw the Cap away, place it on the sterile wrapping. Next remove the white cap on the female luer lock on the drainage bottle. Finally take the male luer lock and twist it clockwise onto the female luer lock on the drainage bottle. Ensure that the roller clamp is completely closed.
2. Clean around the valve opening with a fresh alcohol pad while holding the base of the catheter valve in one hand.
3. Align the luer connection on the drain line set with the center of the catheter valve. Push in and turn clockwise to securely tighten.

Begin Drainage

1. Release the slide clamp on the bottle until it no longer pinches the blue tube closed.
2. Begin drainage by opening the roller clamp on the tubing set. Pain or discomfort may occur. To alleviate this slow the flow of drainage by slightly closing the roller clamp.
3. When the flow stops or the bottle is filled, completely close the tubing with the roller clamp.

To Disconnect from a press-fit (non-threaded) catheter

1. After drainage is complete or the bottle is filled, firmly grasp the white valve collar on the catheter and the white collar on the drain line with adapter. Detach the hubs by pulling straight back. A twisting motion may help with the separation.
3. If a second bottle is needed to complete the drainage, open a second sterile bottle and a second sterile Safety Adapter. Do not connect to a drain line with adapter that has already been used. Be very careful to preserve the sterility of these items; only set them on the sterile wrapping. Resume using the prior instructions starting at How to connect to a press-fit (non-threaded) style catheter.
4. Discard old gloves and put on a new pair.
5. Clean the catheter valve thoroughly with a fresh alcohol pad.
6. Firmly press the new Universal Valve Cap onto the catheter valve.

To Disconnect from a threaded Luer Lock Catheter

1. Disconnect the bottle tubing set from the catheter valve by turning the clear locking collar counter

- clockwise and pulling straight back. Replace the previously removed blue cap on the male luer connector on the end of the drain line tubing.
2. If a second bottle is needed to complete the drainage, open a second sterile bottle. Preserve the sterility making sure the bottle and the drain line only touch the sterile wrapping. Resume using the prior instructions starting at How to connect to a threaded Luer Lock catheter.
3. Discard old gloves and put on a new pair.
4. Clean the catheter valve thoroughly with a fresh alcohol pad.
5. Screw the blue Valve Cap found in the Procedure Kit onto the catheter valve.

Final Steps

1. Prepare the Tegaderm™ Dressing by removing the center portion of the non-adhesive side of the paper backing.
2. Peel away the large single piece that has the Tegaderm™ logo on it to expose the adhesive side. Carefully place the dressing back on the work station with the adhesive side up.
3. Clean around the catheter exit site with the remaining alcohol pads. Optional: When dry, apply the Cavilon™ Barrier Film.
4. Carefully place the split foam catheter pad around the catheter at the exit site.
5. Gently wind the catheter in a circle on top of the foam pad, taking care not to kink the catheter.
6. Place three or four gauze pad on top of the catheter and hold them down.
7. Pick up the Tegaderm™ Dressing and center it over the gauze pads, pressing it down evenly. Remove the remaining paper from the dressing and press down evenly.
8. If emptying bottle contents: remove the blue bellow by cutting at the third section from the top. Make this cut larger (3/4 way through bellows) to allow the bellows to be pulled open wide for convenient opening. Once the bellows are opened, cut the blue tube and discard. Empty bottle in toilet or discard as required.
9. Remove gloves and discard

If you have any questions or concerns please consult your physician.